



CARRARA TOWER  
LONDON, EC1V  
£3,466 Per Month

T. +44 (0) 20 7935 0011  
E. [enquire@napierwatt.co.uk](mailto:enquire@napierwatt.co.uk)  
[WWW.NAPIERWATT.CO.UK](http://WWW.NAPIERWATT.CO.UK)

**NAPIER WATT**  
PROPERTY CONSULTANTS

## Description

Located in the heart of zone 1 and within easy reach of Old Street, the City and Shoreditch, 250 City Road is a landmark development designed by world renowned architects Foster + Partners. With apartments finished to a superb specification alongside 5\* facilities and wifi-enabled landscaped gardens you have everything on your doorstep to enjoy a living experience like no other. The property comprises

of 1 double Bedroom a large open plan kitchen/living space. 250 City Road Carrara Towers has a Gym, Fitness Studio and outdoor Yoga. There is also a spa and an indoor pool within the building.

Islington Council Tax Band F. EPC Rating B.

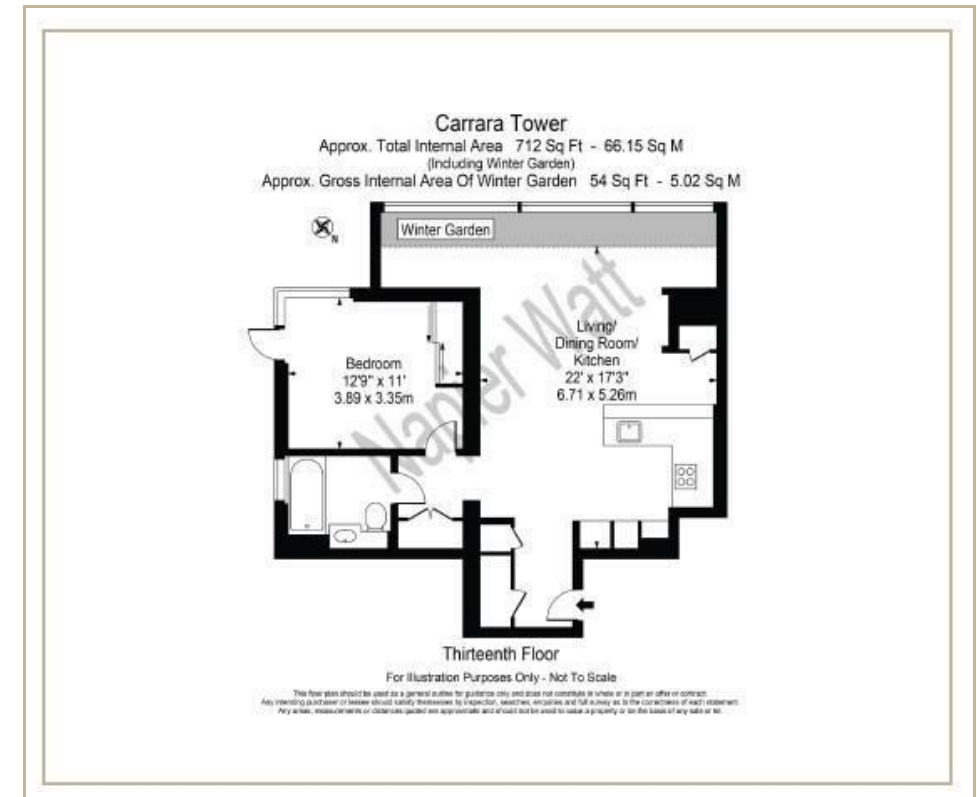

## TERMS

Fees & Charges: Tenancies exceeding £100,000 Per annum £480 inc VAT, Tenancies where a company is a tenant £480 inc VAT.

**For Clarification** we wish to inform prospective purchasers that we have prepared these sales particulars as a general guide. We have not carried out a survey, nor tested the services, appliances and specific fittings. Room sizes are approximate and rounded: they are taken between internal wall surfaces and therefore include cupboards/shelves, etc. Accordingly, they should not be relied upon for carpets and furnishings. Formal notice is given that all fixtures and fittings, carpeting, curtains/blinds and kitchen equipment, whether fitted or not, are deemed to be removable by the vendor unless specifically itemised within these sales particulars.

T. +44 (0) 20 7935 0011  
 E. [enquire@napierwatt.co.uk](mailto:enquire@napierwatt.co.uk)  
 WWW.NAPIERWATT.CO.UK

**NAPIER WATT**  
 PROPERTY CONSULTANTS